

- NOTES:**
- MORE RESTRICTIVE MN/DOT CRITERIA APPLIED TO RUNWAY 9 APPROACH WITH 40:1 N.I.P. SURFACE
 - NEARLY ALL TERRAIN IS WOODED W/APPROX. 40-60' TREES
 - HEIGHT RESTRICTIONS APPLY FOR A DISTANCE NOT TO EXCEED 1.5 MILES BEYOND THE PERIMETER OF THE AIRPORT BOUNDARY, AND UNDER THE APPROACH ZONES FOR A DISTANCE OF TWO MILES FROM THE AIRPORT BOUNDARY

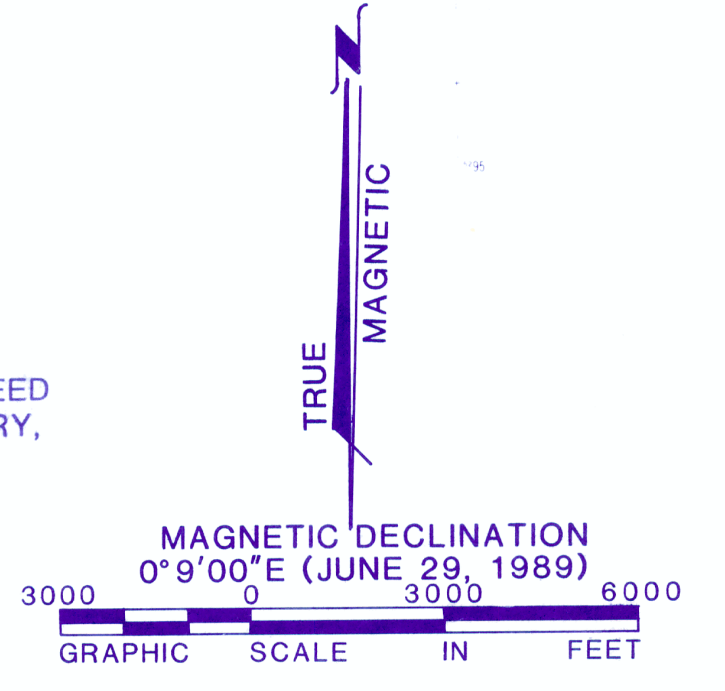

By	Date	Description
		REVISIONS

I hereby certify that this plan, specification, or report was prepared under my direct supervision and that I am a duly Registered Landscape Architect under the laws of the State of Minnesota.

Merland J. Otto *Merland J. Otto*
 Date 7/22/91 Reg. No. 15713

Designed by: MO
 Drawn by:
 Checked by: MO

Hakanson Anderson Assoc., Inc.
 Engineers, Surveyors & Landscape Architects
 222 Monroe Street, Anoka, Minnesota 55303
 612/427-5860

GRAND MARAIS-COOK COUNTY AIRPORT
COOK COUNTY
GRAND MARAIS, MINNESOTA

SCALE:
 Horiz. 1" = 3000'
 Vert.
 Book
 Page

HEIGHT LIMITATION ZONING PLAN

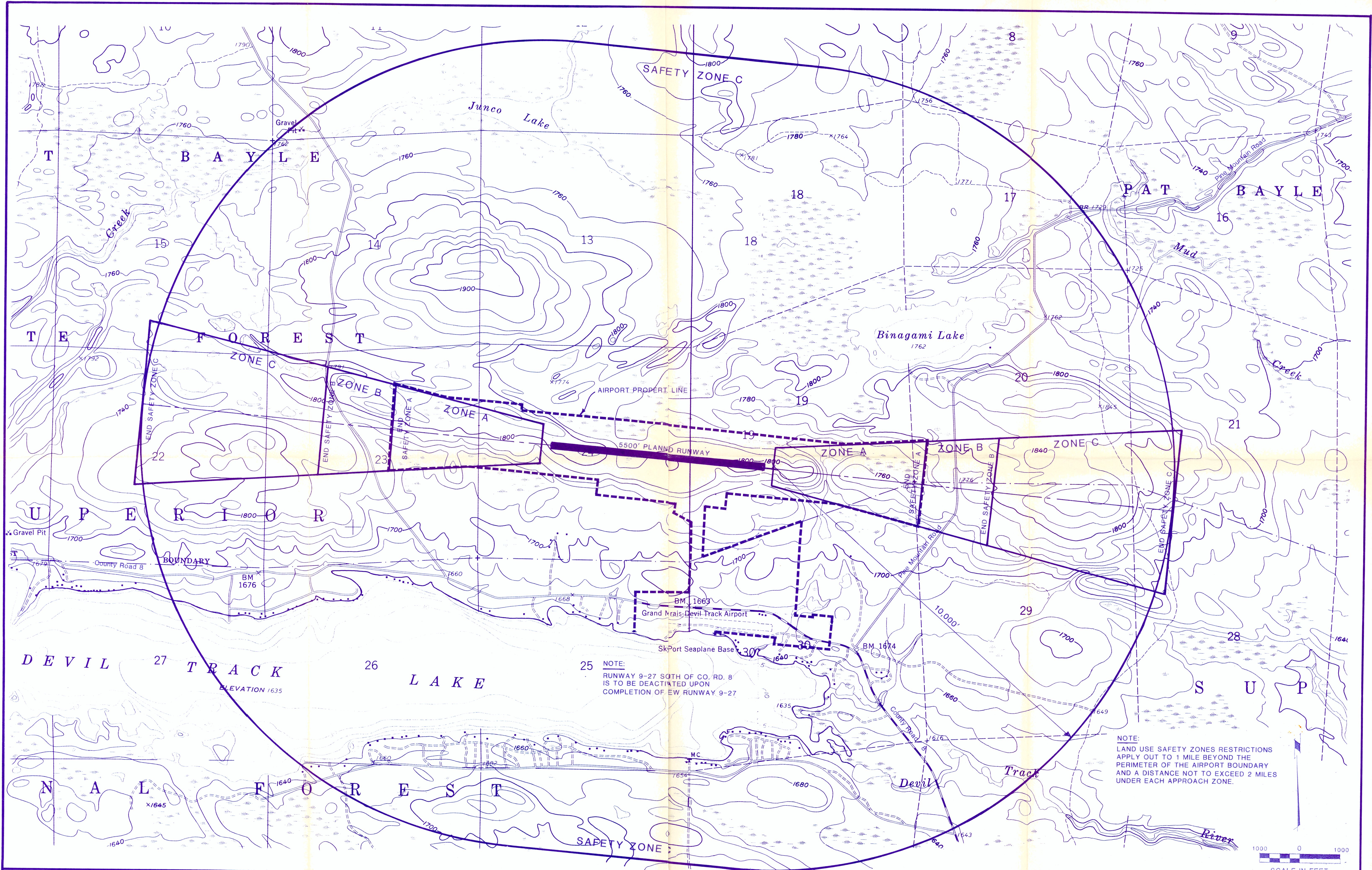

NOTE:
 RUNWAY 9-27 SOUTH OF CO. RD. 8
 IS TO BE DEACTIVATED UPON
 COMPLETION OF EW RUNWAY 9-27

NOTE:
 LAND USE SAFETY ZONES RESTRICTIONS
 APPLY OUT TO 1 MILE BEYOND THE
 PERIMETER OF THE AIRPORT BOUNDARY
 AND A DISTANCE NOT TO EXCEED 2 MILES
 UNDER EACH APPROACH ZONE.

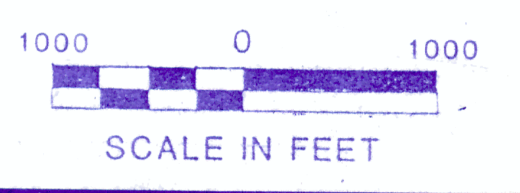

I hereby certify that this plan, specification, or report was prepared under my direct supervision and that I am a duly Registered Landscape Architect under the laws of the State of Minnesota.	
By: Merland J. Otto	Date: 7/22/91
REVISIONS	

Designed by: MO	Hakanson Anderson Assoc., Inc. Engineers, Surveyors & Landscape Architects 222 Monroe Street, Anoka, Minnesota 55303 612-427-5860
Drawn by: GS	
Checked by: MO	
Reg. No. 15713	

GRAND MARAIS-COOK COUNTY AIRPORT
 COOK COUNTY
 GRAND MARAIS, MINNESOTA

Scale:

**AIRPORT
 LAND USE
 SAFETY ZONING PLAN**

Sheet	2 of 2
Date	7/22/91
File No.	1242.17